



# Challenger Middle School

**“We touch the future; we teach!”**

10810 Parkdale Avenue  
San Diego, CA 92126  
(858) 586-7001

[www.challengerms.org](http://www.challengerms.org)



### Office Hours

6:30 a.m. – 3:00 p.m.

### Student Day

7:15 a.m. – 1:55 p.m.

Must be in seat when bell rings at 7:15 a.m.

**Students may enter campus at 6:45 a.m.**

**Any student not enrolled in an after school class, participating in a club, or tutoring must be off campus by 2:15 p.m.**

**Principal - Mrs. Moran**

**Vice Principals - Mr. Bauer, Ms. Joseph**

**My Counselor \_\_\_\_\_**

**Mascot – Cheetah**

**School Colors – Columbia Blue and Royal Blue**

### Bell Schedule

Advisory- 7:15- 7:32

Period 1- 7:37 - 8:30

Period 2- 8:35 - 9:28

Period 3- 9:33 - 10:26

1<sup>st</sup> lunch- 10:31 – 11:01 / Period 4 10:31 – 11:24

Period 4- 11:06 - 11:59 / 2<sup>nd</sup> Lunch 11:29 – 11:59

Period 5- 12:04 - 12:57

Period 6- 1:02 - 1:55

### Minimum Day Bell Schedule

Period 1 – 7:15 – 8:00

Period 2 – 8:05 – 8:45

Period 3 – 8:50 – 9:30

Period 4 – 9:35 – 10:15

Period 5 – 10:20 – 11:00

Period 6 – 11:05 – 11:45

### **My Class Schedule**

Period	Subject	Teacher	Room
Advisory	_____	_____	_____
1:	_____	_____	_____
2:	_____	_____	_____
3:	_____	_____	_____
4:	_____	_____	_____
5:	_____	_____	_____
6:	_____	_____	_____

### **2011-2012 SCHOOL CALENDAR** **FALL SEMESTER**

September 6	School Opens
October 14	End of Grading Period-1 <sup>st</sup> Progress Report
October 21	Students Take Home 1 <sup>st</sup> Progress Report
November 11	Veterans Day Observed
November 21-25	Thanksgiving Holiday
December 2	End of Grading Period-2 <sup>nd</sup> Progress Report
December 9	Students Take Home 2 <sup>nd</sup> Progress Report
Dec 19-Jan 2	Winter Break
January 16	Martin Luther King’s Birthday/Holiday
January 27	Fall Semester Ends-Final Semester Grade

### **SPRING SEMESTER**

January 30	Spring Semester Begins
February 3	Students Take Home 1 <sup>st</sup> Semester Report Card
February 17	Lincoln’s Birthday-Holiday
February 20	Washington’s Birthday-Holiday
March 9	End of Grading Period-1 <sup>st</sup> Progress Report
March 16	Students Take Home 1 <sup>st</sup> Progress Report
April 2-6	Spring Break
April 27	End of Grading Period-2 <sup>nd</sup> Progress Report
May 4	Students Take Home 2 <sup>nd</sup> Progress Report
May 28	Memorial Day
June 12	Last Day of School-Final Semester Grade
Final report card mailed home by the district two weeks later	

**Policies will be updated as needed. Check website for current information. (www.challengerms.org)**

## General School Information – Alphabetical by Subject

### Academic Honesty Policy

“Honesty” is often defined as truthfulness and trustworthiness. One of the goals of Challenger Middle School is to teach these values to students. While students have strong limitations on our campus, they also have the freedom in which to practice the higher values of integrity, honesty, and trustworthiness. As in the larger society, however, there will be times when certain students will not make proper choices and abuse this freedom. When an instance of cheating occurs, it is the responsibility of the school to react, so that when a student is dishonest, he/she learns a valuable, lifelong lesson about the importance of being honest. Acts of academic dishonesty are of major importance to Challenger and include the following:

**Cheating on Tests or Assignments:** A student is cheating when he/she is guilty of dishonesty on any exam, quiz, or assignment – or when he/she knowingly assists another in dishonesty on any exam, quiz, or assignment.

**Forgery:** A student is guilty of forgery when he/she is guilty of imitating or counterfeiting another person’s signature, work, data, disk, and/or homework assignments.

**Plagiarism:** A student is guilty of plagiarism when he/she is caught copying another student’s work, data, disk, homework assignments, and/or textbook material (including any published print and electronic material) and is claiming the work as his/her own.

**Theft or Alteration of Materials:** A student would be guilty of theft or alteration of materials if he/she is caught stealing, exchanging, or altering test documents, class materials, and/or teacher’s records. This includes a student involved in selling, distributing or accepting stolen testing materials - or a student who refuses to cooperate in an investigation of cheating.

**Consequences will include one or more of the following:**

- Students will receive a zero on the assignment, quiz, or test.
- A second violation may result in an “F” and/or “U” grade for the grading period.
- Referral to a Vice-Principal with possible suspension.
- Student will receive a referral to a counselor.
- The teacher will notify parent.



### A.S.B. – Associated Student Body

The purpose of A.S.B. is to promote school spirit and develop leadership. ASB officers apply and are selected based on grades, citizenship and recommendations. These students model leadership and promote teamwork within the Challenger Community. Every student is automatically a member of the Associated Student Body.

### Attendance – Every Day Counts! Higher Attendance Equals Higher Achievement

**Absences** – When a student is absent, the student’s parent/guardian must call or send a note to the Attendance Office. The district’s Connect-Ed system will make automated phone calls and send automated emails when students are absent or tardy. If an absence has not been cleared after five (5) days, it will be considered “Unexcused”. Please be sure to have your correct contact information on file with the Attendance Office.

**Excessive Absences** - Students who have excessive absences may enter into a process called Student Attendance Review Board (S.A.R.B.) which may lead to court intervention if absences continue to be a problem.

**Excused Absences** – The State of California only excuses certain types of absences which include illness, doctor or dentist appointments, injury or personal/family emergencies. For details regarding district and state attendance policies, please check the [Facts for Parents](#) booklet sent home at the beginning of the school year or the district’s website, [www.sandi.net](http://www.sandi.net).

**Doctor’s Appointments, Early Dismissal** – A parent/guardian must request an early dismissal for a student by phone call or note to the Attendance Office – not the child’s teacher. Please call as soon as possible. It may take up to 15 minutes to retrieve the student from a classroom, especially PE class. Any student leaving campus early without a blue release slip is considered truant.

**Extended Absences/Contracts** – A parent or guardian must notify the Attendance Office (not the teacher) for a Contract of Independent Study five school days in advance. If a contract is not obtained, this absence will be unexcused. Extended trips/personal leaves are discouraged during the school year.

**Letters for Excessive Absences** - The district has a set schedule of when letters are mailed home regarding absences they consider to be more than normal. Please view your child’s attendance record through your ParentConnection account or call the Attendance Office if you have a question.



**Tardies and Truancies** – If a student is tardy or truant, he/she may receive consequences such as lunch-clean up, detention, or in-school suspension. In an effort to notify parents of tardies, the Connect-Ed program reports tardies via an automated phone call to phone numbers on file.

**Tardy Sweep** - Unannounced sweeps will take place during the school year. During a tardy sweep, teachers are instructed to close their doors when the bell rings and send students who are tardy to the auditorium. All students who are tardy to school on the day of a tardy sweep will be issued detention.

### Tardy Policy

Tardy #	Action	Person Responsible
1	Verbal warning	Teacher
2-3	Personal conversation Teacher consequences including call home, lower citizenship grade, lunch clean-up, teacher detention *If concerns about an individual student's situation arise earlier, go straight to action for tardy #4	Teacher & Student Teacher & Student
4	Teacher will complete blue counseling referral Conference and Parent contacted Tardy contract	Teacher Counselor & Student Counselor & Student
5+	Referral to Counselor Parent conference arranged Detention assigned	Counselor VP, Counselor, Student, Parent VP & Student

**Books – Library and Textbook** - You may visit the Library Media Center before school, during lunch and after school each day. During class hours, you must have a pass from your teacher to be admitted. The library staff is here to help you. Be sure to ask for help if you can't find something.

*Please observe the following rules when using the Library Media Center:*

1. Students must have a pass in order to go to the library during class time.
2. Books are checked out at the circulation desk only with an I.D. card.
3. Observe the due dates stamped in the books you select. Books are checked out for two weeks.
4. Students with overdue books will be charged a fine of 5 cents per day for regular books circulating two weeks.
5. Drinks, gum and food are not allowed.
6. Be considerate. No loud talking or disruptive behavior. Other people have the right to silence when they are working.

Textbooks will be issued through the Library Media Center. **All textbooks issued to students must have a protective book cover.** Although all textbooks are furnished free of charge, **students are required to pay for any losses or damages beyond “normal wear.”** If a book is lost, the student must pay for the cost of the book. A detailed page of damage fines and textbook prices is given to students when they check out textbooks. It is also posted on our website.

**Bullying and Harassment Education** - Bullying or harassment is not tolerated at Challenger. We have initiated a harassment education program to educate students about the types of harassment including sexual harassment and harassment based on bigotry or prejudice. We discuss the aggressor, victim and bystander roles and consequences for harassing others. Students learn how to diffuse a harassment situation and how to report such behavior. This proactive approach empowers students to advocate for themselves and stand up to bullying. Posters reinforcing these messages are displayed throughout the school.

Students can also take advantage of the “Stop Bullying” Program. If students are uncomfortable reporting harassment to a staff member, whether they are a witness or victim, they may complete a form found in easily accessible areas throughout the school and deposit the form in the Stop Bullying box in the library. Counselors will review the forms and contact the appropriate students to assess the situation.

#### Teasing vs. Harassment

- Has the victim asked the aggressor to stop the behavior?
- Does the victim PERCEIVE (see or feel) the behavior as harassment?
- What is the intent of the aggressor?
- Is the behavior physically or emotionally hurtful?
- How long has the situation been occurring?

#### You are encouraged to ask yourself these questions:

- Would I be hurt or upset if someone were saying or doing this to me?
- Would my parents be upset if they knew I was doing this?
- Would the other person's parents be upset if they knew about this?
- If the adults in the school knew, would I be in trouble about this?

If the answer to any of these questions is “YES”, the behavior is considered harassment.

**WHAT IS HARASSMENT?**

Any Form of Unwanted, Deliberate, or Offensive Behavior That Someone Has Asked Another to Stop

**WHAT YOU SHOULD DO IF YOU ARE BEING HARASSED AT SCHOOL**

- 1. TELL THE PERSON TO STOP**  
Speak clearly  
Say it loud enough for the person to hear  
“LEAVE ME ALONE”  
“STOP HARASSING ME”  
“STOP BOTHERING ME”  
“I TOLD YOU YESTERDAY- STOP THAT”  
**DO NOT** add to the problem by name-calling or insulting the aggressor
- 2. IF IT CONTINUES, REPORT IT**  
Tell the truth to your teacher, counselor, parents, administrator, school police officer, security personnel or another trusted adult.  
School staff will talk to the aggressor about the inappropriate behavior and consequences will be assigned.
- 3. IF IT STILL DOESN'T STOP, REPORT IT AGAIN**  
At this stage, an administrator, counselor or school police will become involved.

**Challenger Middle School**





HARASSMENT  
TEASING  
BULLYING

IT'S ALL ABOUT  
RESPECT



“We Touch the Future, We Teach”  
Challenger Middle School

**Bus Eligibility** - Only students who have originally enrolled at Challenger through the PISC or VEEP Programs are eligible for transportation services. Neighborhood students are required to provide their own transportation.

**Bus Problems** - Late Bus - Contact the district's Transportation Department at 858-496-8460.

Lost Items on Bus - Contact the district's Transportation Department at 858-496-8460.

Missed Bus - If student is going to be absent or late, contact Challenger's Attendance Office at 858-586-7001.

Discipline Issues on Bus - Contact your child's counselor at 858-586-7001.

## **Bus Rules**

1. Be at the bus stop on time.
2. Show respect at all times in your voice, tone, and body language.
3. Follow all school/bus rules and bus driver directions.
4. Do not get off the bus once you have boarded the bus.
5. No food or drink allowed on the bus.
6. Cell phones are not to be used on the bus unless there is an emergency. Students may use cell phones at the direction of an adult.
7. Have your bus pass ready every day. It is your school ID card with a bus sticker. Students who do not have a bus pass may not be allowed on the bus and parent will have to pick the student up from school. Temporary bus passes are only issued before school or at lunch.
8. If you lose your ID card, you must purchase a replacement for \$2.00. Challenger will give you the first ID card for free.

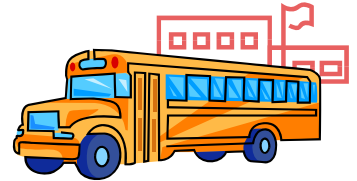

If these policies and/or procedures are violated, a staff member and bus driver will apply the following supports in a consistent manner. Repeated loss of bus pass will result in lunch clean-up and/or detention. For complete set of rules and policies, see the booklet "Information about Your School Bus Service" published by San Diego City Schools and distributed at the beginning of the year with your bus stop information.

1<sup>st</sup> Offense: Warning, parent contacted

2<sup>nd</sup> Offense: Seat Change, parent contacted and student is issued consequences

3<sup>rd</sup> Offense: Bus referral to counselor

If a student does not follow the assigned consequences, the student will advance to the next step in the list of consequences.

*Consequences for not following bus rules may include the following:*

- After-school detention, in-school suspension, lunch detention, lunch clean-up, suspension from riding bus
- A parent conference may be held at any time

**Bus - Staying After School** - Students who ride the bus may only stay after school to ride the late bus if they have school business such as P.E. make-ups, a club meeting, intramural sports, or tutoring. The student must have parent permission and teacher permission before staying after school. Students must remain with the teacher until the after school bus pickup time. Students are not allowed to leave campus and then return to take the late bus. Not all transportation routes have a close bus stop. Students should check the late bus stop list before staying after school. If a student stays late without permission, a parent may be required to pick the student up from school.

### Late Bus Pass Check List

- ✓ Check bus stop list for close bus stop.
- ✓ Get a late bus pass from teacher.
- ✓ Get teacher permission & signature.
- ✓ Get parent permission & signature.
- ✓ Stay after school with teacher until bus is scheduled to leave.
- ✓ Be on time for bus departure.
- ✓ Show late bus pass and ID card to bus driver.

**Bus Stop Changes** - Changes in bus stops can only be made through written request of the parent to Challenger's Bus Liaison. This process takes two weeks to implement. Students are only allowed to get on and off at their assigned bus stops.

**Cheetah Pride!**

**CATSpectations** – Community, Attitude, Tolerance and Scholarship

The CATS Program encompasses character education, intervention systems and student recognition in support of the following philosophy:

**Community** – Your community can be your neighborhood, family, friends, school, businesses, libraries, parks, etc. Do your best to make it safe, caring and clean. It starts with you!

**\*Be Caring \*Be Responsible**

**Attitude** – You are in charge of your attitude each day. You can choose to react to a situation positively or negatively. The choice is up to you!

**\*Have Fun \*Be Positive**

**Tolerance** – The world is made up of all different kinds of people. Wouldn't it be a boring place if we were all the same? Strive to respect, accept, and learn from each other!

**\*Be Compassionate \*Be Accepting**

**Scholarship** – Always do your best and take pride in anything and everything you do. Push yourself above and beyond people's (and your own) expectations of yourself. If you always do your best, you will have no regrets. Autograph everything you do with excellence!

**\*Explore Your World \*Learn New Things**



**Clubs/Student Activities** - Students may participate in teacher sponsored clubs after school. School clubs are offered for a variety of interests and are sponsored by staff members each school year. Announcements regarding meeting dates and times can be found in the daily bulletin.

**Communicating with Teachers and Counselors** – You may email staff members through the links provided on Challenger's website or you may call the school. If a teacher is not available, a message will be left in the teacher's box. Teachers pick up their mail and check their email a minimum of once a day so please allow time for them to respond during a time when they are not teaching a class. You are encouraged to call for an appointment to be sure the person you would like to see is available. We will do our best to accommodate drop-in visits, however, you may be asked to schedule an appointment. A parent/teacher conference may be scheduled at any time during the school year and can be arranged directly with the teacher. If you would like to meet with more than one teacher at the same time or would like your child's counselor to be included in the meeting, please contact your student's counselor for assistance. If you feel you need more assistance after communicating with the teacher, please contact your student's counselor or one of the site administrators.

**Connect-Ed** - This program is a way for the district, the school and teachers to make automated calls and send automated emails to contact parents/guardians. Please be sure your contact information is current.

**Contact Information** - Any changes to contact information must be made through the Attendance Office. Please update phone numbers, addresses, and the names of emergency contacts as soon as anything changes.

**Counseling and Guidance** - Every student will have access to the counselor who will be able to help with school or personal problems. The counselor will make any necessary schedule changes, help plan your school program, provide academic and personal guidance and provide many other areas of assistance. Students may request an appointment with the counselor by filling out a "Request to See Counselor" form. These forms are available in every classroom and in the Counseling Office. Parents may request an appointment by calling the office.

**Crosswalks and Traffic** - All students must use the crosswalks especially when crossing in the front of the school on Parkdale Ave. For the safety of our children, parents are asked to obey traffic signs and not make U-turns in front of the school. Help us to be a good neighbor and do not park in front of someone's driveway. This is illegal and neighbors have been advised to call the police when this occurs.

**8<sup>th</sup> Grade Party and Promotion Ceremony Participation Criteria** - Challenger Middle School's first priority is preparing students for high school both academically and socially. We look forward to celebrating the accomplishments of our eighth graders at the end of the school year with a party and promotion ceremony. In order for eighth graders to be promoted to high school and participate in these activities, it is essential that students maintain appropriate academic progress and behavior throughout the school year. **Any major behavior problems at any time may be cause for students to be ineligible for the party or promotion activities.** The participation criteria will be distributed to students and parents in the fall.

**Grades/Progress Reports/Report Cards** – We expect all students to maintain passing academic grades and good citizenship. Students are issued progress reports every six to seven weeks with the final report card issued at the end of each semester. The progress reports and report cards (white 8" x 11" sheet of paper) are given to students to take home along with a Grade Verification Form (colored 8" x 5.5" sheet of paper) where parents sign verifying that they received the original set of grades. The Grade Verification Form is returned to the advisory teacher. The second semester report card is mailed home by the district two weeks after school ends.

Student progress, progress reports, and report cards may also be viewed via the Internet with a ParentConnection or a StudentConnection account. The school and teachers will utilize the auto-dialer program to make automated reminder calls about grades. Parents may contact teachers via phone or email to receive additional progress information. If you do not have access to the Internet, parents may contact the student's counselor or the student may stop by the office for an updated printout.

Grade reporting dates are listed in the student planner, on the website, and on a flyer "Dates to Remember" which is sent home on the first day of school. Please mark your home calendars and parents, don't forget to ask students for progress reports/report cards.

**Health and Nutrition** – Good nutrition makes for healthy bodies and healthy minds. We ask that your child have a good breakfast before coming to school so they are ready to learn. Food and beverages that are sent to school should be nutritious and low in sugar content. Energy drinks such as Red Bull, Monster and sodas are not appropriate and are discouraged from being sent to school. The free/reduced breakfast/lunch program is available to those who qualify; applications are available in the front office and can be completed at anytime during the school year.

**Health Services** - The Health Office is available to students during school hours each day.

- All on-campus injuries must be reported to the Health Office.
- All students must have a current emergency card on file in the Health Office.
- To attend school, students must meet immunization requirements.
- Medication:
  - Motrin and Tylenol are available to students who have a "Health Information Exchange Consent" form completely filled out and on file at school. The nurse will assess the situation, the student's health history and dispense medication according to protocol. Only a licensed nurse can dispense these medications.
  - All other medications are not allowed to be carried by the student.
  - If other prescribed and over-the-counter medications are routinely required at school, a physician's order is required.
- All doctor excuses for Physical Education and "five minute" passes are generated through the Health Office.
- **Asthma And the Use of Inhalers at School** - Students who use inhalers as prescribed by their physicians should have a duplicate inhaler brought to school to be kept in the Health Office. It is acceptable for students to carry and self-administer their inhalers; however, **ONLY** with the written permission of both the physician and parent. The permission form for inhalers at school, Authorization for Asthma Medications to Be Taken during School Hours, may be obtained in the Health Office.



Students who feel ill must go to the Health Office on a pass. Students are not allowed to call on a cell phone or from a classroom to be picked up from school. The nurse will determine the course of action and if the student should go home due to illness.

**Homework** - Students are expected to write down their homework assignments in the planner, complete the homework, and return it to the teacher on time. Each student attending Challenger Middle School should read for a minimum of 30 minutes each night. Please refer to the school's website if your child has questions about nightly homework or if he/she is absent for one or two days. Homework is not available individually until the third day of absence for illness.

The average time students are expected to spend on homework is listed below:

Grade 6 - 1 hour per night

Grade 7 - 1 ½ hours per night

Grade 8 - 2 hours per night



**ID Cards** - ID cards are required for many school activities. The first one is free. Replacements cost \$2.00 and may be paid for at the Financial Office. Students will be given a receipt to take to the library to have a replacement ID card created.

**Lost and Found** – If you should find anything of value, please turn it in to the Finance Office. Any found items left at the end of the school year will be donated to charity. If you have lost:

- Valuables such as a wallets, watches, purses, jewelry, etc., check with the Finance Office
- Clothing or a notebook, check the Lost and Found
- PE clothes, check with the PE teacher, then the Lost and Found near the Cafeteria
- Textbook or a library book, check at the Library

**Messages for Students** – We will only take a message for a student in cases of emergency.

**Moving** - Please notify the Attendance Office whenever a student moves to a new address. If the student will be moving to a different school, the Attendance Office must be notified a few days in advance so transfer documents can be prepared.

**ParentConnection** - Parents/guardians are highly encouraged to sign up for an account in ParentConnection via Challenger’s website ([www.challengerms.org](http://www.challengerms.org)) which will enable you to monitor your child’s homework assignments, grades, test scores and attendance via the Internet. Parents may share the PIN and password information with other family members or other adults involved in your child’s life to help monitor and support your child in order to succeed in school.

**Parent Involvement** – Parents are a critical part of a student’s support system. Challenger encourages and expects involvement at all levels including our volunteer program, PTSA and several parent committees. Please sign up for an account in ParentConnection. Parents also need to look at and sign their child’s planner each week to make sure the child is establishing good organizational habits by keeping track of assignments, tests and quizzes.

**Passes** - No passes will be issued the first or last ten minutes of each period. When leaving a classroom, you must have your planner/pass signed by the teacher.

**PE Uniforms** - Official Challenger Physical Education shorts and t-shirts are the required PE uniform. Students are required to have a substitute set (Sub Set) of gym clothes kept in a large zip-lock bag in their locker. This is to be used in case the student forgets their primary uniform. The Sub Set consists of one t-shirt and one pair of shorts in plain gray or blue. Students may also use plain gray or blue sweat shirt and pants during cold weather. The clothes used for the Sub Set and sweats cannot have hoods, pockets, logos, buttons or zippers. For safety reasons students must wear shoes that tie. When physical education attire becomes torn, ripped or defaced such as writing other than name, the garment must be replaced. Clothes such as sweaters, jackets, shorts or shirts may not be worn over or under the physical education uniform. Each student must also provide a towel and a combination lock. PE clothes and a lock may be purchased in the financial office at the beginning of the school year. Replacements may also be purchased there in the event any of the items are lost. In cases where a student has forgotten PE clothes and they are brought in for the student, the student will be issued a lunch clean-up. Students need to use their planners and backpacks to become organized and independent.



**Rainy Day Procedures** - Students are asked to walk under the covered walkways and stay out of the rain as much as possible. P.E. classes will conduct indoor activities. Students may eat lunch under the covered patio area or in the auditorium will also be open to students. Students should follow the dress code and wear appropriate footwear, clothing, jackets, and outerwear to protect themselves from the cold and wet weather. Umbrellas are permitted at school when used properly for inclement weather. Parents are asked to monitor weather reports and prepare alternative transportation arrangements if necessary. In addition, traffic congestion is always worse on rainy days. Please plan ahead and leave the house early. Traffic delays are not an excused reason for being tardy.

**Schedule Changes** - Student and/or parent initiated requests will be decided by the principal with the following in mind:

- Was a parent conference held to solve the problem?
- Can the change be readily made without disruptions to the present schedule?
- Is there a teacher recommendation for the change?
- Does this change more clearly meet the career and/or educational goals of this student?
- Has there been sufficient time to allow interventions to succeed?

Program changes cannot be given because, “I changed my mind,” “I don’t like this teacher or period,” “My friend is taking this class,” “It’s too cold in the morning to take PE,” or “It’s too hot in the afternoon to take PE,” “The teacher is too hard,” etc...

**School Supplies and Student Planner** - Good organization and study habits established now will help you achieve your goals for the future. Each student will receive a free student planner where you are expected to write your homework assignments. Lost planners must be replaced. They are available in the Finance Office for \$5.00. You will be required to bring to class every day the following materials:

- |  |                          |   |
|--|--------------------------|---|
| 1 ½"- 2" metal three ringed binder   | 1 or 2 erasable ink pens | 1 calculator (scientific with fraction key preferred) |
| 8 organized tab dividers with slide-in labels  | 1 highlighter pen        | 1 pocket divider (2 pockets)                          |
| 4 or 5 #2 sharpened pencils with erasers   | 1 large plastic pouch    | 1 small box of colored pencils                        |
| paper (8 ½ " by 11" wide or college ruled)   | 1 pkg. graph paper       | 1 small bottle of alcohol-based hand sanitizer        |
| 1 - 12 inch ruler with metric & inch measurements  | 4-5 spiral notebooks     |   |
| PE uniform, shoes, sub set of clothes and combination lock – see PE Uniform section for detailed description |                          |   |



**StudentConnection** - Students may sign up for their own account in StudentConnection which will allow them to view homework assignments, grades, test scores, and attendance record via the Internet. They must sign a StudentConnection Responsibility Contract and then a PIN and password will be issued. Student accounts will be handled through the office and advisory classes.

**Trash and Recycling** - Students must throw away trash in trash cans. If you are walking home, do not throw the trash on the ground. Be a nice neighbor and throw it away when you get home. We recycle paper, cans and bottles at Challenger. Please place items in the correct bins.

**Visitors** - For security purposes, visitors are asked to sign in at the Main Office and state their purpose for the visit. Parents are welcome at any time. Classroom visits must be arranged with the individual teacher prior to the visit. Students not enrolled at Challenger are not allowed on campus at any time unless accompanied by a parent.

**Website** – The most current information about school news, policies, and homework assignments is posted on Challenger’s website, [www.challengerms.org](http://www.challengerms.org). Parents and students should regularly check the site.

## School Discipline Code

Students who do not follow school rules and procedures are subject to disciplinary action by a school official. This action may take the form of lunch detention, after-school detention, a parent conference, an intervention plan, lunch clean-up, campus beautification, Saturday School, in-school suspension which includes after-school detention and community service, suspension from regular school attendance or expulsion.

**Policies will be updated as needed. Check website for current information. ([www.challengerms.org](http://www.challengerms.org))**

<b>Hallway and Bathroom Rules and Expectations</b>				
When students are on campus, they must follow the hallway rules listed below. Students using the hallways in the 900 building must follow the special directional rules for efficient and safe movement through the hallways, stairwells, and balcony walkways.				
	<b>Hallways</b>	<b>Upper 900 Building</b>	<b>Lower 900 Building</b>	<b>Bathrooms</b>
<b>C</b>	Courtesy	Clockwise	Crank up the courtesy	Clean up after yourself
<b>L</b>	Lower your voice	Leave to the left	Leave to the outside	Leave food and drink outside
<b>A</b>	Always stay to the right	Away from the rail	Always stay to the right	Always flush
<b>W</b>	Walk and talk	Walk and talk	Walk and talk	Wash your hands
<b>S</b>	Smile	Smile	Smile	Show respect

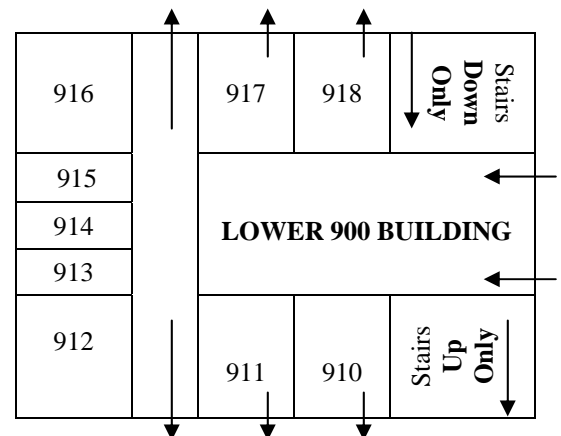
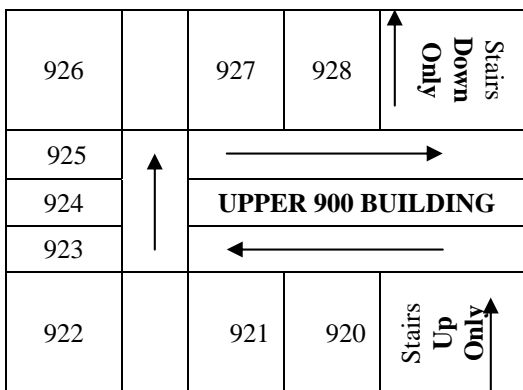

## Basic Classroom Rules

1. BE HERE!
2. Be seated when the bell rings.
3. Be prepared – books, notebooks, paper, pen, sharpened pencil, etc.
4. Listen and follow directions.
5. Be courteous. Raise hand before speaking.
6. Respect the rights, opinions, and property of others.
7. Work without talking or disturbing anyone.
8. Use class time appropriately. Avoid note writing, hair combing, applying makeup, etc.
9. No gum allowed on campus.
10. Place waste paper in trash cans and recycled items in correct bins.
11. Remain in your seat until dismissed by your teacher.
12. Walk to your next class – no running on campus.
13. Cell phones must be turned off and out of sight.
14. iPods and other electronic devices must be turned off and out of sight.

1. **WEAPONS** – Weapons such as paintball guns, nunchakus clubs, chains, firearms, knives, ninja stars, and pellet guns are forbidden by law. Knives of any size, even scouting knives, Swiss army knives, razor blades, and pocketknives are never to be brought to campus for any reason. San Diego Unified School District has adopted a Zero Tolerance Policy concerning students who possess weapons or are engaged in repeated fights and/or acts of violence. Any student who has an object considered to be a weapon will be referred to the vice-principal for immediate suspension and investigation by School Police Services Department and/or the San Diego Police Department for expulsion. (Penal Code <P.C> 626.10) (Education Code <E.C.> 48910)



2. **EXPLOSIVE/FLAMMATORY OBJECTS** – Possession or use of any explosive such as firecrackers, poppers, bomb bags, stink bombs, or similar items may result in an immediate suspension from school. This section applies to the possession/usage of matches and lighters as well. Be advised that the Municipal Code of San Diego, Section 53.10(b)(2) states that “It is a misdemeanor to possess or explode firecrackers on campus.” A referral may be made to School Police for violations of this provision.
3. **ASSAULT** – Any student who is involved in an unprovoked attack or an assault on any student or adult (verbal or physical threat or action) will be suspended from school and will be referred to School Police Services Department, which may conduct an investigation for possible expulsion. (P.C. 240.242, E.C. 44014)
4. **BALLOON/FLOWER BOUQUETS/BIRTHDAY CAKES** – Birthday cakes/food, flowers, balloon bouquets or other gift items are not allowed on campus. Do not bring them to school or have them delivered.

5. **CAMERAS/CELL PHONE CAMERAS/VIDEO CAMERAS and PHOTOGRAPHS/VIDEO RECORDING** – These devices are not allowed on campus at any time. If a student is caught with a camera, it will be confiscated and only returned to parent or guardian. No photography or video recording on campus without permission. Posting of school videos or photographs on the Internet is not allowed.



6. **CELL PHONES, PAGERS & OTHER ELECTRONIC SIGNALING DEVICES** - Challenger administration and staff strongly encourage students **NOT** to bring any valuables to school including cell phones due to theft risk. The school is not responsible for lost or stolen items. These devices must be kept out of sight and turned off during the school day. They may be used only before and after school **off campus**. Cell phones may be confiscated if used on campus and will only be returned to a parent or guardian. Administration will not investigate lost/stolen valuables such as iPods, cell phones, toys, etc.

7. **COMPUTER/INTERNET USE** – Students must have SDUSD Student Network Responsibility Contract on file before using any computer at school. This contract outlines responsibilities, acceptable use, privileges, network etiquette, security and vandalism policies under the Network Use Guidelines. Students must follow the Network Use Guidelines. Violations may result in cancellation of computer privileges.

### DO NOT BRING VALUABLES TO SCHOOL

Students are advised never to leave purses, backpacks, personal property or objects of value unattended, even for a few seconds. Challenger administration and staff strongly encourages students not to bring anything of value to school. Administration will not investigate lost/stolen valuables such as iPods, cell phones, toys, etc. **The school is not responsible for lost or stolen items. If you must bring money on campus, please keep it in your pants' pockets.**

Do not leave money in your backpack.

8. **CYBERBULLYING/CYBERTHREATS** - Safe learning environments are necessary for students to learn and achieve high academic standards. Therefore, bullying, cyberbullying, and cyberthreats will not be tolerated. Cyberbullying or cyberthreats include, but are not limited to the following misuses of technology under a person's true or false identity: harassing, teasing, intimidating, defaming, threatening, terrorizing, or otherwise intending to harm, insult, or humiliate another staff or student member by way of any technological tool, such as sending or posting inappropriate or derogatory email messages, instant messages, text messages, sound, digital pictures or images, social websites, blogs, chat rooms, or website postings. (E.C. 32261)
9. **DEFIANCE** – Any student who defies any adult or refuses to follow his/her directions or refuses to give their name will be referred to the appropriate authority for disciplinary action.
10. **DISRUPTION** – Any student who deliberately disturbs or hampers classroom instruction or school activities will be immediately referred for disciplinary action. (E.C. 10609, District Procedure 2619) This includes the possession and/or use of stink bombs, which is a suspendable offense.
11. **DRUGS/ALCOHOL** – Possession or use of narcotics, dangerous drugs, or alcohol is a violation of the law. Students involved with or possessing narcotics or alcohol will be suspended and referred to School Police Services and/or the San Diego Police Department. (E.C. 48904)
12. **EXTORTION OR THREATS** – Any students involved in obtaining money or other possessions of value through the use of intimidation or violence will be suspended. An investigation by School Police Services may be required. (Extortion: P.C. 518, Threats: P.C. 519)
13. **FIGHTING** – Fighting, including playing fighting, is strictly forbidden. Students who fight will be referred to the counselor or vice principal for disciplinary action and suspension. After three fights inflicting injury within one year, the student will be required to attend a Zero Tolerance Program. For details, see the district's Zero Tolerance Policy.
14. **FOOD AND DRINK IN CLASSROOMS** – Food and drink are not allowed during normal classroom hours. There may be some exceptions under teacher supervision.
15. **GAMBLING** – Gambling in any form is prohibited by state law. Gambling is defined as wagering or betting money on the outcome of any activity. Students who are involved in this activity may be suspended. Students should not have dice or cards or anything that can be considered a gambling device in their possession at school. These will be taken from students. (Administration Code 301, E.C. 10601-10609)
16. **GUM** – Gum is not allowed on campus even after school (not in pockets, backpacks, purses, etc.) This means no gum at lunch. Violators may be referred for disciplinary action including campus beautification.
17. **INSTIGATING** – Students who instigate problems, unsafe situations or misbehavior will be considered a participant and will receive appropriate consequences for their actions.
18. **LASER POINTERS** - No student shall possess a laser pointer on campus. (P.C. 417.27) Pointing a laser pointer in a threatening manner may be a misdemeanor. (P.C. 417.25)
19. **LEAVING CAMPUS WITHOUT PERMISSION** – Students may not leave campus without permission. Leaving campus without a Blue Slip is considered a truancy. (District Procedure 2380)
20. **MISBEHAVIOR GOING TO AND FROM SCHOOL** – Students are subject to disciplinary action for any form of misbehavior in the process of going to and from school. (District Procedure 2619)
21. **MP3 PLAYERS, IPODS, ETC.** – Challenger administration and staff strongly encourage students **NOT** to bring any valuables to school including electronic devices due to theft risk. The school is not responsible for lost or stolen items. MP3 players, portable radios, CD players, including earphones, if brought to school must be kept out of sight and turned off during the school day. These devices may be confiscated if used during the times not permitted and will only be returned to a parent or guardian. Administration will not investigate lost/stolen valuables such as iPods, cell phones, toys, etc.



22. **PERMANENT MARKERS/AEROSOL CANS** – Permanent markers and aerosol cans are not permitted on campus.
23. **(a) PROFANITY/PORNOGRAPHY** – The use of offensive words or profanity is unacceptable. Obscene actions, possession of pornographic materials, or habitual profanity can lead to suspension. **(b) SLAM BOOKS** – Slam books are not allowed on the school campus. These will be confiscated and may be returned only to the parent.
24. **STUDENT FUNDRAISING** – The only fundraising allowed on campus is that for school sponsored activities. No other candy or food can be sold on campus. Students may not sell candy from school fundraisers on campus. Students are responsible for their own fundraising items.
25. **STUDENT TRANSPORTATION** – Skateboards or roller-blades are not allowed on campus at any time. All bikes must be locked in the bike racks. Students are responsible for securing their bikes with a personal lock. All bike riders must obey all traffic laws and school bicycle regulations, or face bicycle suspension. According to state law, helmets must be worn. Bicycles are not to be ridden on campus. Students must use the crosswalk at **all** times. Bikes should be walked in front of the school at all times. **SKATEBOARDS, ROLLERBLADES AND SCOOTERS (RAZORS) ARE NOT ALLOWED.** (San Diego Municipal Code 84.12)
26. **THEFT** – Any student involved in the theft or attempted theft of school or personal property will be suspended. This includes receiving stolen property. School Police Services contact may be required. Challenger administration and staff strongly encourage students **NOT** to bring any valuables to school due to theft risk. Students are encouraged not to bring large amounts of money to school or to leave backpacks/purses unattended. Thefts must be reported immediately to the vice-principal.
27. **TOUCHING AND HARASSMENT** – Public display of affection (kissing, romantically embracing, etc.) is never allowed on school grounds. Inappropriate touching of another’s body is forbidden and will be dealt with as a serious matter requiring an investigation for disciplinary intervention. The rule is “Keep your hands off others at all times.” Harassment can be such actions as unwelcome sexual advances; requests for sexual favors; or verbal, visual, physical conduct of a sexual nature. Bullying will not be tolerated. See district policy of Student Nondiscrimination and Sexual Harassment for more details.
28. **TOBACCO** – Students involved in the use of tobacco on any part of the school grounds will be suspended. Possession of tobacco on campus is also grounds for suspension. Students are not to have any form of tobacco (smokeless tobacco, chew packets, and betel) in their possession at school or during school activities. This policy also extends to the possession and/or use of matches and lighters. (Education Code 48900-20) Refer to district policy.
29. **TOYS** – Toys (such as yo-yos, darts, stuffed animals, handheld electronic games [i.e. PSP, Gameboy], baseball cards, game cards, finger boards, water guns, squirt bottles, squirt guns, pacifiers, marbles, etc.) are not to be brought to school. They will be confiscated and only returned to a parent/guardian. Administration will not investigate lost/stolen valuables such as iPods, cell phones, toys, etc.
30. **TRESPASSING** – Students are not to be on campus after school hours or on weekends unless they are participating in a school-related activity with staff participation.
31. **VANDALISM** – Anyone who maliciously damages or defaces school property or that of another person is required by law to pay for damages. This includes defacing school property with permanent marker or felt pen. Immediate suspension and possible police contact may be required. (P.C. 594) Permanent pens are not allowed on campus.

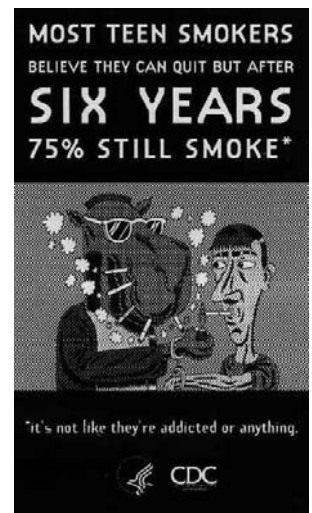

**The Crime Stoppers Hotline**  
**for emergency use:**  
**1 (619) 235-TIPS.**  
 Call to report a crime and  
 remain completely anonymous.

## Challenger Dress Code

In order to promote the pursuit of excellence and develop responsible citizens of good behavior, the following codes for dress are required for all students and are not negotiable. If the items of clothing or accessories are deemed inappropriate by school personnel, the student will be required to change and may be issued disciplinary consequences.

### **Pants, shorts and skirts**

- Worn at the waist, no sagging - may be required to wear zip-tie if sagging
- Not skin tight
- Skirts and shorts no shorter than mid-thigh when seated

### **Midriffs and immodest clothing**

- Straps must be greater than 2 inches wide
- No low cut armholes
- No tummy exposed when arms are raised
- Low cut tops are inappropriate, no exposed cleavage

### **Shirts**

- Cannot depict any profanity, violence, drugs, alcohol, tobacco, sexual act or is offensive to any gender, ethnicity, or faith

### **Shoes**

- Must be closed toe and have a closed back
- No slippers
- Heels cannot exceed 2 inches

### **Hats, caps, and hoods**

- Not permitted unless a doctor's note is given

### **Jewelry**

- Must be appropriate for school
- Cannot depict any profanity, violence, drugs, alcohol, tobacco, sexual act or is offensive to any gender, ethnicity, or faith

### **Miscellaneous**

- Any clothing, accessories, or colors that are associated with gangs are prohibited; this includes wallet chains, bandannas, hairnets, gloves, excessive jewelry, etc.
- Sunglasses are not to be worn unless prescribed by a doctor
- Pajamas are not allowed
- Trench coats are prohibited
- Writing on the body is not allowed
- A jacket, sweater, sweatshirt, etc. may not be worn to cover-up inappropriate clothing.

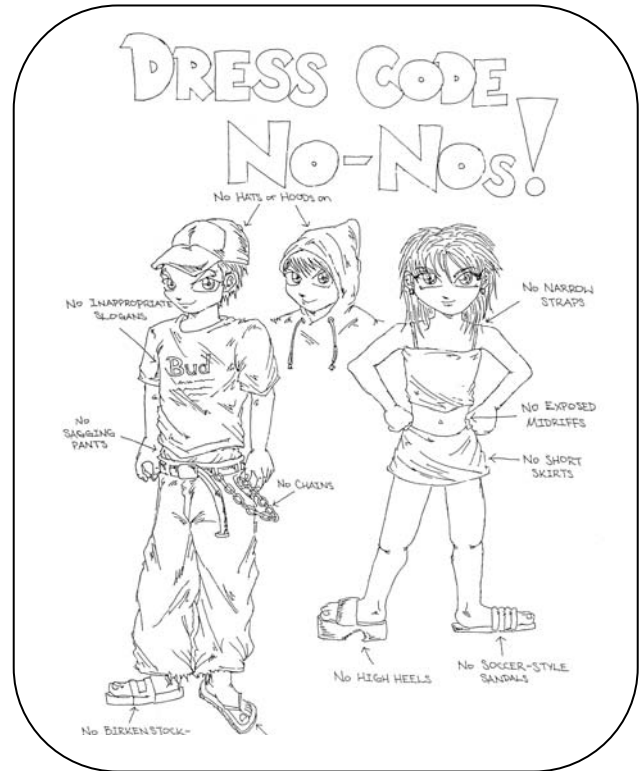

**We Touch the Future; We Teach!**

### Challenger Alma Mater

*Oh Challenger, we honor you as we go through life,  
We'll think of you and what we learned  
as we face our life's strife.  
As we move on through the days,  
our thought will oft return  
To the friends we made, the joys we shared,  
They will stay throughout the years.*

### **HISTORICAL NOTE**

Our school is named in honor of the space shuttle *Challenger*. On January 28, 1986, the space shuttle *Challenger* disintegrated during lift-off due to equipment failure, ending the lives of all seven crewmembers. These astronauts: *Sharon Christa McAuliffe*, the first teacher in space; *Francis Scobee*, mission commander; *Michael J. Smith*, shuttle pilot; *Ronald E. McNair*, mission specialist; *Gregory B. Jarvis*, payload specialist; *Ellison S. Onizuka* and *Judith A. Resnik*, mission specialists, who trained and worked together, represented the hope and diversity of America.

The name "*Challenger*" captures the energy and the inspiration associated with commitment to success. It dares one to go beyond one's limits, to have high expectations, to touch the future. The crew's love for their country, commitment to excellence and appreciation of education were elements that led to their success. The memory of that crew will serve as a role model for our multi-ethnic student population.

## In Case of an Emergency

All district schools have developed a comprehensive school safety plan that meets state requirements. The safety plan includes procedures that help us keep a safe and orderly environment for all students. Emergency procedures are discussed with students and teachers every year.



Challenger regularly practices emergency drills in case of fire, natural disaster or other emergencies requiring a lockdown. Our goals in any emergency are:

- To keep students and staff in a safe environment
- Stay calm
- Facilitate an orderly evacuation to the back area of the campus
- Account for every student and adult on campus

**Fire** – A continuous short bell will ring. All buildings are evacuated. Students walk with the teacher to the back area of the school.

**Earthquake** – A long bell of about 15 seconds will ring. A few minutes later, the fire bell will ring. If you are inside, move away from windows, drop to the floor and cover your head with your hands. If you are outside, move away from all buildings and overhead wires, drop to ground and cover your head with your hands. When the area has been determined safe, an all clear bell will sound, and students will be escorted to a safe area.

**Lockdown** – In the case of an intruder on our campus, a long continuous bell will ring. Students need to go into the closest open room. Teachers will lock the door, turn off the lights and shut the blinds. Students will be directed to go to the designated safe area for that room and/or lay on the ground. When the area is determined to be safe, police will evacuate the school; room by room. Students and staff will reunify at the back grass field area. In the event of a real lockdown, police will assume authority for the situation, and we will follow their instructions.



**Parent Action in Case of Emergency** – Remain calm. In the specific cases of emergency, where students will be dismissed early, signs will be posted with instructions. We will have to follow school, district and police instructions to reunify parents with students. This may take some time, so please be patient.

### **Additional emergency tips for parents:**

1. Be sure your child has important contact information memorized - home, cell and work phone numbers for both parents. This is great information to write in your child's planner.
2. Remind your child of the name and phone number for an adult to use as an alternate emergency number.
3. Have an alternate plan for rides, or plan to walk to or from school. Make sure your child knows his/her own address and route to the house in case he/she needs to walk home or direct someone driving to the house.
4. Post the "School Dates to Remember" flyer on the refrigerator so you know when holidays and minimum days are occurring.
5. Notify the school of any changes in home address and home or work phone numbers.
6. Be sure we have on file all numbers and names of adults who we can release your child to in the event of an emergency.
7. Notify the school of any restraining orders and any court or custody issues that may involve the school or your child.
8. Report any concerns or suspicions that you may have to a teacher, counselor or administrator. If you prefer to remain anonymous, please call the Campus Crime Stopper Hotline at 619-235-TIPS (619-235-8477).

**Policies will be updated as needed. Check website for current information. ([www.challengerms.org](http://www.challengerms.org))**

# SAN DIEGO UNIFIED SCHOOL DISTRICT

## Student Nondiscrimination and Sexual Harassment Policy

### NOTICE OF STUDENT NONDISCRIMINATION

San Diego Unified School District is committed to equal opportunity for all individuals in education. District programs and activities shall be free from discrimination based on sex, sexual orientation, gender, ethnic group identification, race, ancestry, national origin, religion, color and mental or physical disability or any other unlawful consideration. The district shall promote programs which ensure that discriminatory practices are eliminated in all district activities and will take steps to assure that the lack of English will not be a barrier to admission and participation in district programs.

Any student who engages in discrimination of another student or anyone from the district may be subject to disciplinary action up to and including expulsion. Any employee who permits or engages in discrimination may be subject to disciplinary action up to and including dismissal.

Any student or parent/guardian who feels that discrimination has occurred should immediately contact a teacher or the principal for resolution at the site. If the issue cannot be resolved, the student or parent should contact: Amy J. Bozone, Legal Services Office, San Diego Unified School District, 4100 Normal St., Room 2148, San Diego, CA 92103. For questions or additional information please call (619) 725-5630.

### STUDENT SEXUAL HARASSMENT POLICY

San Diego Unified School District is committed to making the schools free from sexual harassment. This means that the district prohibits harassment made by someone from or in the educational setting. Sexual harassment can be such actions as unwelcome sexual advances; requests for sexual favors; or verbal, visual, or physical conduct of a sexual nature made by someone from or in the educational setting.

The district prohibits conduct that has the purpose or effect of having a negative impact on the student's academic performance, or of creating an intimidating, hostile, or offensive educational environment.

The district further prohibits sexual harassment in which a student's grades, benefits, services, honors, program or activities are dependent on submission to such conduct.

Students should report any sexual harassment to their school principal, vice principal, counselor, or teacher. Students who violate this policy shall be disciplined appropriately. This includes suspension or possible expulsion. Employees who violate this policy shall be disciplined according to personnel procedures (AP 7110).

The district believes that it can resolve issues of harassment and discrimination at the school site.

If not, students or parents/guardian may contact: Amy J. Bozone, Legal Services Office, San Diego Unified School District, 4100 Normal St., Room 2148, San Diego, CA 92103. For questions or additional information please call (619) 725-5630 or on-line at: [http://www.sandi.net/depts/title\\_ix.html](http://www.sandi.net/depts/title_ix.html).

### TO FILE A DISCRIMINATION OR SEXUAL HARASSMENT COMPLAINT

1. **Filing a complaint:** A complaint may be filed by a student or parent/guardian by obtaining a copy of the Sexual Harassment Complaint Form or Uniform Complaint Form and Administrative Procedure 0112 on-line, from the school, or the district's Legal Office. Remedies available outside of the district are listed in this procedure. The complaint should be filed with the principal at the complaining student's school.
2. **Investigation:** San Diego Unified School District will immediately undertake an effective, thorough, and objective investigation of the harassment allegations and provide a written report within sixty (60) days of when the complaint is filed.
3. **Action:** If the district determines that its policies prohibiting sexual harassment or discrimination have been violated, disciplinary action, up to and including expulsion will be taken.

The person filing the complaint may also pursue action in civil court. Complaints will be kept confidential.

The district prohibits retaliation against any participant in the complaint process. Each complaint shall be investigated promptly and in a way that respects the privacy of all parties concerned.

**A student who has a complaint of discrimination or sexual harassment should contact a teacher or principal for resolution at the school site. If the complaint cannot be resolved, the student should contact:**

**Amy J. Bozone  
Legal Services Office  
San Diego Unified School District  
4100 Normal Street, Rm. 2148  
San Diego, CA 92103**

For questions or additional information please call (619) 725-5630.